

**KL. 461, 481, 561, 951**

cordonatori destri  
*right cording feet*



**99999-99367** - 7,0 mm  
**99999-99368** - 5,4 mm  
per cerniere  
*zipper feet*



**99999-99365** - 5,4 mm  
**99999-99366** - 7,0 mm

bilaterali  
*bilateral foot*

feritoia 3 mm  
*slit size 3 mm*

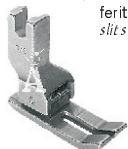

**99999-98010**

compensatori con guida  
*compensating feet with guide*



cordonatori sinistri  
*left cording feet*

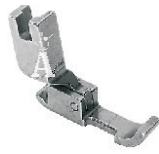

**99999-99369** - 7,0 mm  
**99999-99370** - 5,4 mm  
per cerniere regolabile  
*adjustable zipper foot*



**99999-99372**

doppia compensazione  
*double compensation foot*



**99999-98110**

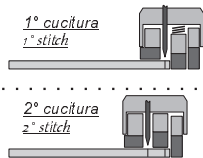

codice <i>code</i>	1°guida 1°guide	2°guida 2°guide	esempio cuciture <i>stitch example</i>
<b>99999-98210</b>	1/32" (0,8 mm)	1/4" (6,3 mm)	
<b>99999-98212</b>	1/32" (0,8 mm)	5/16" (8,0 mm)	
<b>99999-98214</b>	1/32" (0,8 mm)	3/8" (9,5 mm)	
<b>99999-98216</b>	1/32" (0,8 mm)	1/2" (12,7 mm)	
<b>99999-98218</b>	1/16" (1,6 mm)	1/4" (6,3 mm)	
<b>99999-98220</b>	1/16" (1,6 mm)	5/16" (8,0 mm)	
<b>99999-98222</b>	1/16" (1,6 mm)	3/8" (9,5 mm)	
<b>99999-98224</b>	1/16" (1,6 mm)	1/2" (12,7 mm)	

**KL. 463, 483, 563, 953**



**91-051742-23**

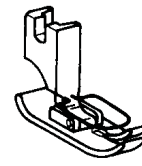

**91-051736-03**



**91-155599-21**

**KL. 487, 489**

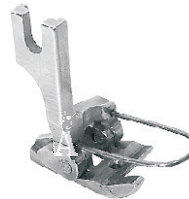

**15634**  
(=91-055578-93)

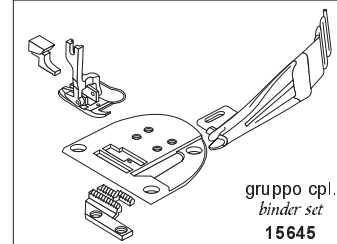

**KL. 9020**



**541566**  
(= 35-415660-00)

**KL. 145, 245, 545, 1245, 335**

Piedini per cuciture normali - *standard stitch feet*  
KL. 145, 245, 545, 1245

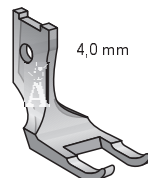

**91-046970-04/01**



**91-040474-93/58**

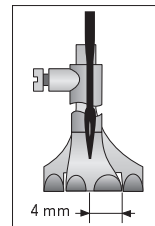

Piedini per cuciture normali - *standard stitch feet*  
KL. 145, 245, 545, 1245, 335



**91-040461-93/58** - 4,0 mm  
**91-040461-93/59** - 5,0 mm  
**91-040461-93/60** - 6,0 mm  
**91-040461-93/61** - 7,0 mm  
**91-040461-93/62** - 8,0 mm  
**91-040461-93/63** - 9,0 mm  
**91-049039-35/02** - 10,0 mm  
**91-049039-35/03** - 11,0 mm

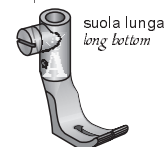

**91-040474-93/58** - 4,0 mm  
**91-040474-93/59** - 5,0 mm  
**91-040474-93/60** - 6,0 mm  
**91-040474-93/61** - 7,0 mm  
**91-040474-93/62** - 8,0 mm  
**91-040474-93/63** - 9,0 mm



**91-040475-04/51** - 4,0 mm  
**91-040475-04/52** - 5,0 mm  
**91-040475-04/53** - 6,0 mm  
**91-040475-04/54** - 7,0 mm  
**91-040475-04/55** - 8,0 mm  
**91-040475-04/56** - 9,0 mm

