

F66

GUIDA PER PASSANTI

Per macchine piane a 2 aghi
For 2 needles flat bed machines

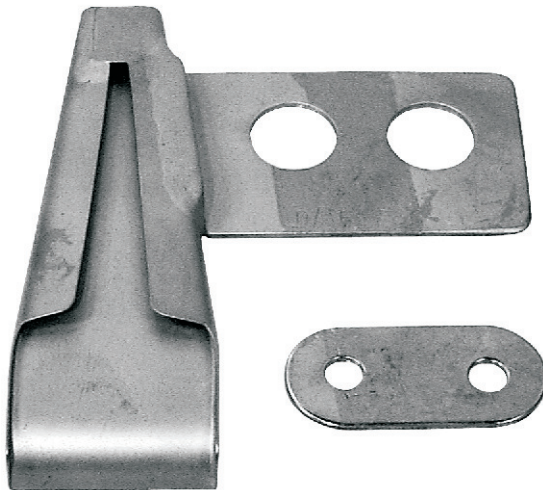

BELT LOOP FOLDER

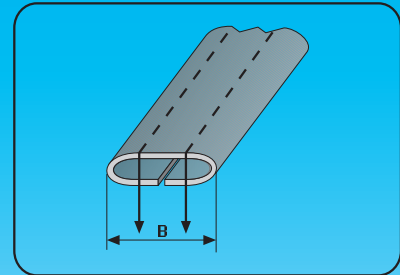

Codice	Entrata (A) (tape size)		Lav. finito (B) (finished size)		Spessore (S) (thickness)
	(mm)	(inch)	(mm)	(inch)	
F66/12	12	31/64	6	1/4	M
F66/14	14	9/16	7	9/32	M
F66/16	16	5/8	8	5/16	M
F66/18	18	3/4	9	11/32	M
F66/20	20	25/32	10	25/64	M
F66/22	22	7/8	11	7/16	M
F66/25	25	1	12,5	1/2	M
F66/28	28	1-1/8	14	9/16	M
F66/30	30	1-3/16	15	19/32	M
F66/32	32	1-1/4	16	5/8	M
F66/35	35	1-3/8	17,5	11/16	M
F66/38	38	1-1/2	19	3/4	M
F66/40	40	1-9/16	20	25/32	M
F66/45	45	1-3/4	22,5	57/64	M
F66/50	50	2	25	1	M
F66/55	55	2-3/16	27,5	1-3/32	M
F66/60	60	2-3/8	30	1-3/16	M

F69

GUIDA PER PASSANTI

Per macchine a punto invisibile
For blindstitch machines



BELT LOOP FOLDER

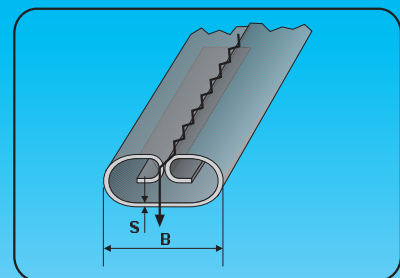

Codice	Lav. finito (B) (finished size)		Spessore (S) (thickness)
	(mm)	(inch)	
F69/8L	8	5/16	L
F69/8M	8	5/16	M
F69/8H	8	5/16	H
F69/10L	10	25/64	L
F69/10M	10	25/64	M
F69/10H	10	25/64	H
F69/12L	12	1/2	L
F69/12M	12	1/2	M
F69/12H	12	1/2	H



F69A - staffa (bracket)