

KI. DVK 1702-3, DWK 1802-3, V 7002-3, V 7102-3, W 8002-3, W 8102-3, WX 8802-3

Piedini 2 aghi per meccanismo rifilatore (EMK)
Presser feet (2 needles) for fabric trimmer mechanism (EMK)

KI. DVK1702EMK, DWK1802EMK

KI. V7002EMK, V7102EMK, W8002EMK, W8102EMK

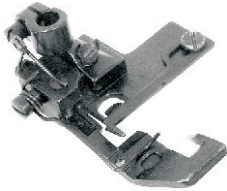

Piedino 2 aghi
Presser foot (2 needles)
cod. **17-8280-1** (1/8")
cod. **17-8380-1** (5/32")
cod. **17-8480-1** (3/16")
cod. **17-8580-1** (7/32")
cod. **17-8680-1** (1/4")

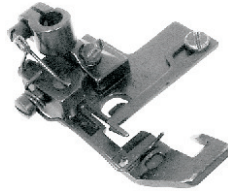

Piedino 2 aghi
Presser foot (2 needles)
cod. **17-8290-1** (1/8")
cod. **17-8390-1** (5/32")
cod. **17-8490-1** (3/16")
cod. **17-8590-1** (7/32")
cod. **17-8690-1** (1/4")

KI. DVK1703EMK, DWK1803EMK

KI. V7003EMK, V7103EMK, W8003EMK, W8103EMK

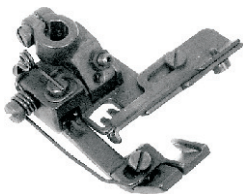

Piedino 3 aghi
Presser foot (3 needles)
cod. **17-8880-1** (7/32")
cod. **17-8980-1** (1/4")

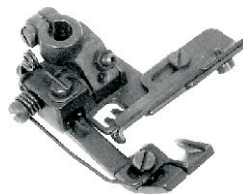

Piedino 3 aghi
Presser foot (3 needles)
cod. **17-8890-1** (7/32")
cod. **17-8990-1** (1/4")

KI. WX8802

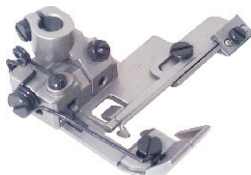

Piedino 2 aghi
Presser foot (2 needles)
cod. **17-7710-1** (1/8")
cod. **17-7720-1** (5/32")
cod. **17-7730-1** (3/16")
cod. **17-7740-1** (7/32")
cod. **17-7750-1** (1/4")

KI. WX8803

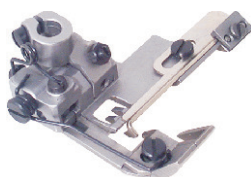

Piedino 3 aghi
Presser foot (3 needles)
cod. **17-7760-1** (7/32")
cod. **17-7770-1** (1/4")

KI. DVK 1702-3, DWK 1802-3, V 7002-3, V 7102-3, W 8002-3, W 8102-3, WX 8702-3, WX 8802-3

Piedini 2 aghi con guida:
per ribattere, per orlare, per inserimento cordino (C)

Presser feet (2 needles) with guide:
for covering and hemming operations (C)

KI. DVK1702, DWK1802, V7002C, V7102C, W8002C, W8102C, WX8702C, WX8802C



Piedino 2 aghi con guida fissa
Presser foot (2 needles) with fixed guide
cod. **17-8470-1** (3/16")
cod. **17-8570-1** (7/32")
cod. **17-8670-1** (1/4")

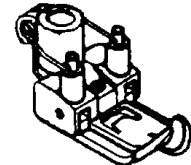

Piedino 2 aghi con guida regolabile
Presser foot (2 needles) with adjustable guide
cod. **17-8310-1** (3/16")
cod. **17-8320-1** (7/32")
cod. **17-8330-1** (1/4")

Piedini 3 aghi con guida:
per ribattere, per orlare, per inserimento cordino (C)

Presser feet (3 needles) with guide:
for covering and hemming operations (C)

KI. DVK1703, DWK1803, V7003C, V7103C, W8003C, W8103C, WX8703C, WX8803C



Piedino 3 aghi con guida fissa
Presser foot (3 needles) with fixed guide
cod. **17-8870-1** (7/32")
cod. **17-8970-1** (1/4") (= 17-894C)



Piedino 3 aghi con guida regolabile
Presser foot (3 needles) with adjustable guide
cod. **17-8170-1** (3/16")
cod. **17-8610-1** (7/32")
cod. **17-8620-1** (1/4") (= 17-894CR)

KI. DPW 1301, 1302
PX 301, 302

KI. DPW 1301S, DPW 1302S, PX 302-4W

KI. DPW 1301W,

KI. DPW 1302W, PX 302-4W

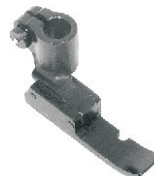

Piedino - Presser foot
cod. **17-3010-1**



Piedino - Presser foot
cod. **17-3020-1**

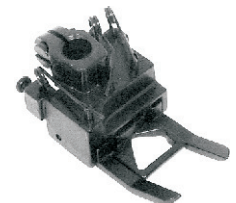

Piedino - Presser foot
cod. **17-3610-1**

Ricambi per piedini - Presser feet's spare parts

Molle per piedini normali e con guida
Standard and with guide feet's springs



Molla sinistra
Left spring
cod. **17-8180-D**
(= 917894/M1)



Molla destra
Right spring
cod. **17-8180-E**



Molla interna
Inside spring
cod. **17-8180-F**



Molla doppia
Double spring
cod. **17-8210-E**
(= 917894/M2)



Guida regolabile
Adjustable guide
cod. **17-8190-K**
(= 917894/P1)



Molla sinistra
Left spring
cod. **17-8190-D**



Molla destra
Right spring
cod. **17-8190-E**



Molla interna
Inside spring
cod. **17-8190-F**



Vite per guida regolabile
Screw for adjustable guide
cod. **87-2970-0** (= 917894/V1)

Molla per piedini per bordare
Binding feet spring



Molla piedini per bordare
Binding feet spring
cod. **17-8260-F**