

# COLTELLI PER TAGLIA-CUCI

## BERNINA - BERNETTE

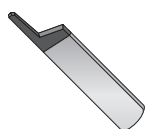

superiore  
cod. **500.178.03**

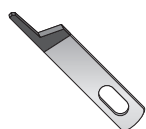

superiore  
cod. **501.434.03**



superiore  
cod. **A1052 1000**



inferiore  
cod. **500.189.03**



inferiore  
cod. **501.454.03**



inferiore  
cod. **A1053 1000**

## JANOME



superiore  
cod. **784045020**



inferiore  
cod. **784048001**



inferiore  
cod. **788013009**

## BROTHER



superiore  
cod. **127734.0.01**



superiore - vidia  
cod. **126598.0.01**



superiore  
cod. **X77119.0.01**



superiore  
cod. **X75059.0.01**



superiore  
cod. **X77668.0.01**  
(= XB0563.0.01)

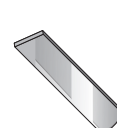

inferiore  
cod. **126601.0.01/01**



inferiore - vidia  
cod. **126601.0.01/11**



inferiore  
cod. **127134.0.01**



inferiore  
cod. **X5007.0.01**



inferiore  
cod. **X75233.0.01**



inferiore  
cod. **X77683.0.01**

## JUKI - RIMOLDI (BABYLOCK)

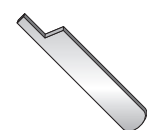

superiore  
cod. **205-9101-01A**



superiore  
cod. **405-9101-01A**

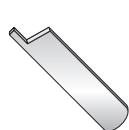

superiore  
cod. **408-9101-01B**

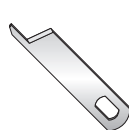

superiore  
cod. **615-9101-01A**



superiore  
cod. **428-9101-01B**

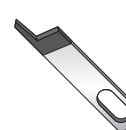

superiore  
cod. **60507**



superiore  
cod. **305248**



superiore  
cod. **PL-91-01A**



superiore  
cod. **PL-Q11-01A**  
(= PL-Q11-01B)

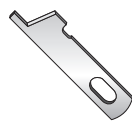

superiore  
cod. **PL-Q11-01C**



superiore  
cod. **B4108-352-00B**

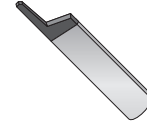

superiore  
cod. **B4108-352-00D**

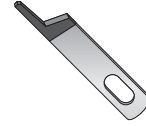

superiore  
cod. **A4142-335-000**

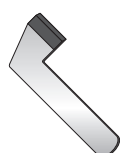

inferiore  
cod. **205-9102-01A**

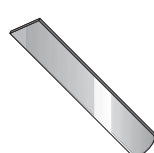

inferiore  
cod. **405-9102-01A**



inferiore  
cod. **408-9102-01A**

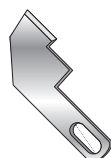

inferiore  
cod. **615-9102-01A**

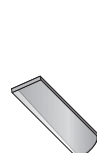

inferiore  
cod. **60544**



inferiore  
cod. **305249**



inferiore  
cod. **A4113-102-000**

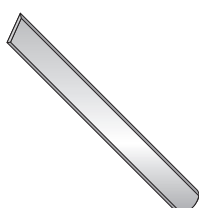

inferiore  
cod. **B4122-352-00A**



inferiore  
cod. **A4145-335-000**



inferiore  
cod. **AM-R11-01A**



inferiore  
cod. **PL-R11-01A**



inferiore  
cod. **HA-R11-01A**



inferiore  
cod. **SE-R11-01A**



inferiore  
cod. **SA-Q81-02A**